

Where should I dump my trash?

Single-Stream Recycling



- **plastic** (except bags, thin films, and utensils)
- **cardboard and paper** (except waxed and/or dirtied paper)
- **paper cartons and pizza boxes** (must not be greasy)
- **aluminum cans, foil, and trays** (must be clean)
- **NO plastic bags, waxed paper, or food/grease residue**

Small Electronics & Plastic Bags



Compost

- **food waste**
- **compostable bags** (provided beside compost bin)
- **NO paper, plastic, metal, or anything not listed above**



Compost bin

Trash

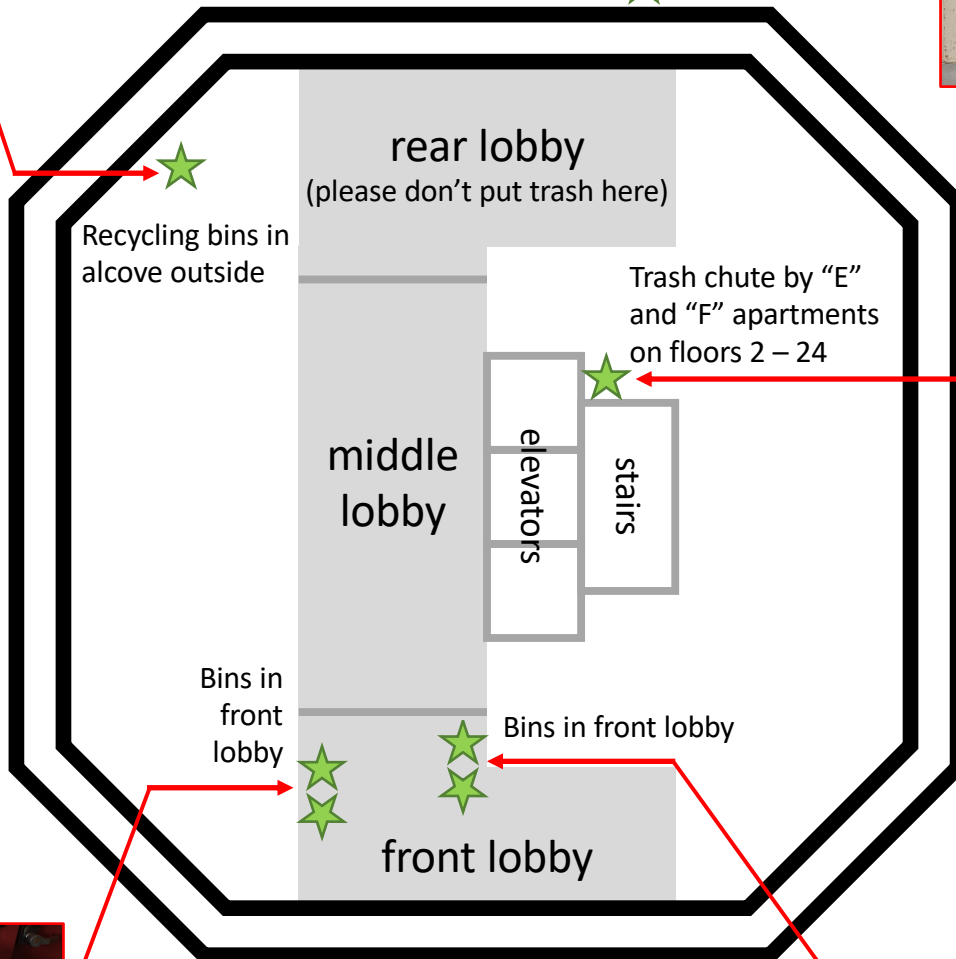

Fluorescent Lightbulbs & Batteries



Questions or Concerns?

Email tang-recycling-gardening@mit.edu